

SERIE CKZ

CONNETTORI CIRCOLARI
AD ELEVATE PRESTAZIONI

GENNAIO 2023



Generalità

La **Serie CKZ** è una rivisitazione della serie **MIL-C-5015**, con le stesse prestazioni elettriche ed ambientali, che presenta alcuni miglioramenti relativi alla manovra di accoppiamento, nella quale la **MIL-C-5015** ha evidenziato nel tempo alcuni punti critici nell'impiego nel settore industriale.

L'accoppiamento a vite di questa norma infatti prevede una filettatura a passo **UN-UNEF**, **passo molto fine**, che presenta una certa difficoltà nell'avvitamento, amplificata notevolmente dalla forza di ritenzione dei contatti, soprattutto nelle taglie maggiori.

La ghiera di accoppiamento **MIL-C-5015** ha dimensioni ridotte, non agevola l'operazione e può accadere che il connettore non venga accoppiato completamente, non essendoci sensazione o evidenza certa della corretta conclusione dell'operazione.

E' evidente che tale condizione è estremamente pericolosa, in quanto la connessione non completata consente il funzionamento, data la forza di ritenzione dei contatti, ma la resistenza alle vibrazioni e la tenuta ambientale sono di fatto compromesse e nel tempo possono condurre a malfunzionamenti.

La **Serie CKZ** supera le criticità sopra esposte con una ghiera di accoppiamento più grande e facilmente maneggiabile, con un **filetto trapezoidale**, che agevola l'operazione di accoppiamento (fig.1).

La filettatura di accoppiamento a profilo trapezoidale è decisamente più performante, rapida e con fine corsa chiaramente avvertibile.

Un o-ring di colore rosso posto sul connettore fisso che viene coperto dalla ghiera di accoppiamento alla chiusura garantisce la correttezza della manovra, introduce una protezione all'ingresso di polveri sul filetto di accoppiamento ed aumenta la tenuta ambientale (fig.2).

La **Serie CKZ** corrisponde alla tenuta **IP67 ed IP69K**, anche in condizioni combinate con urti e vibrazioni.

Figura 1



Figura 2



Technical Data

Material and Platings

COMPONENT	MATERIAL	FINISH
Contacts	Copper Alloy	Silver plated (standard)
Insulator	Polichloroprene -55 + 125°C (standard)	None
Shells, Coupling Nut, Backshells	Aluminum Alloy (standard) Stainless Steel (optional)	Bright Nickel Black Zinc-Nickel None

Contacts

Contact Size	Rated Current at 20°C	Rated Current at 80°C	Max Contact Resistance	Wire Size
18	10 A	7.5 A	12.0 mΩ	18 ÷ 26 AWG
16	22 A	13 A	6.0 mΩ	16 ÷ 22 AWG
12	41 A	23 A	3.0 mΩ	12 - 14 AWG
8	73 A	46 A	1.0 mΩ	8 - 10 AWG
4	135 A	80 A	0.5 mΩ	4 - 6 AWG
0	245 A	150 A	0.3 mΩ	0 ÷ 2 AWG



Contacts

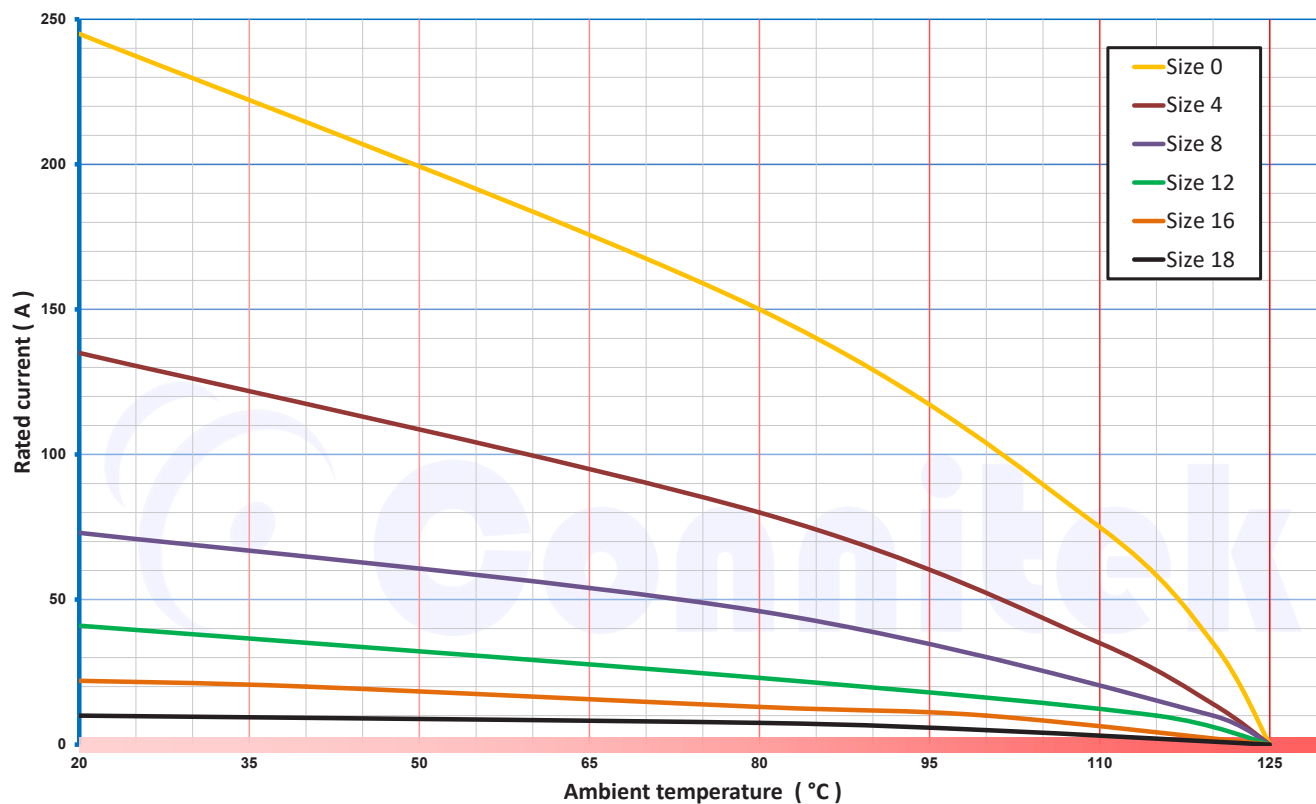

Insulator Service Rating

Class	Operating Voltage Vdc	Operating Voltage Vac RMS	Test Voltage Vac RMS
INST.	250 V	200 V	1000 V
A	700 V	500 V	2000 V
D	1250 V	900 V	2800 V
E	1750 V	1250 V	3500 V
B	2450 V	1750 V	4500 V
C	4200 V	3000 V	7000 V

PIN CRIMP CONTACTS

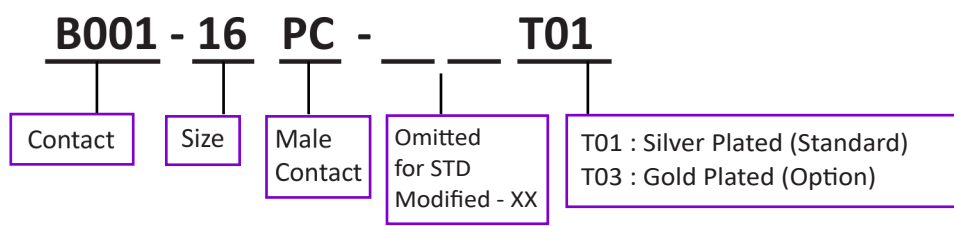
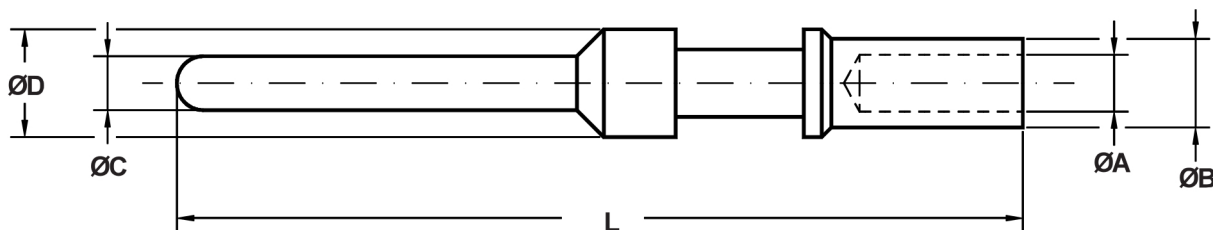

Part Number	Size	Section mm ²	AWG	A	B ±0.1	C ±0.05	D ±0.1	L ±0.1	Modified -XX
B001-18PC T01	18	0.15 / 0.6	26 / 20	1.30	1.93	1.40	2.2	29.60	STD
B001-16SPC T01	16S	1 / 1.5	18 / 16	1.70	2.60	1.58	3.2	26.65	STD
B001-16SPC-13 T01	16S	0.15 / 0.6	26 / 20	1.30	1.93	1.58	3.2	26.65	-13
B001-16SPC-15 T01	16S	1	18	1.50	2.60	1.58	3.2	26.65	-15
B001-16SPC-20 T01	16S	2	14	2.00	2.90	1.58	3.2	26.65	-20
B001-16PC T01	16	1 / 1.5	18 / 16	1.70	2.60	1.58	3.2	31.75	STD
B001-16PC-08 T01	16	0.15 / 0.2	26 / 24	0.85	1.55	1.58	3.2	31.75	-08
B001-16PC-13 T01	16	0.15 / 0.6	26 / 20	1.30	1.93	1.58	3.2	31.75	-13
B001-16PC-15 T01	16	1	18	1.50	2.60	1.58	3.2	31.75	-15
B001-16PC-20 T01	16	2	14	2.00	2.90	1.58	3.2	31.75	-20
B001-16PC-26 T01	16	3	12	2.50	3.80	1.58	3.2	31.75	-26
B001-12PC T01	12	3	12	2.50	3.90	2.38	4.8	37.65	STD
B001-12PC-12 T01	12	0.6	20	1.20	2.60	2.38	4.8	37.65	-12
B001-12PC-20 T01	12	1 / 2	18 / 14	2.00	3.80	2.38	4.8	37.65	-20
B001-12PC-22 T01	12	2.5		2.20	3.80	2.38	4.8	37.65	-22
B001-12PC-30 T01	12	4		3.00	4.80	2.38	4.8	37.65	-30
B001-12PC-38 T01	12	6		3.60	4.80	2.38	4.8	37.65	-38
B001-8PC T01	8	6/8	8	4.50	6.90	3.59	7.8	42.00	STD
B001-8PC-50 T01	8	10		5.00	6.90	3.59	7.8	42.00	-50
B001-4PC T01	4	22	4	7.15	9.53	5.70	11.1	42.00	STD
B001-0PC T01	0	50/60	0	11.50	14.30	9.05	15.1	45.00	STD
B001-0PC-35 T01	0	35		9.00	14.35	9.05	15.1	45.00	-35

All crimp connectors includes silver plated contacts (T01 suffix).
 Standard and modified contacts can be supplied as spare parts.
 See our "Assembly Instructions" catalogue.

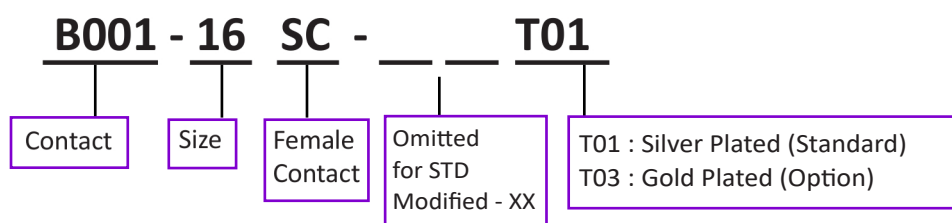
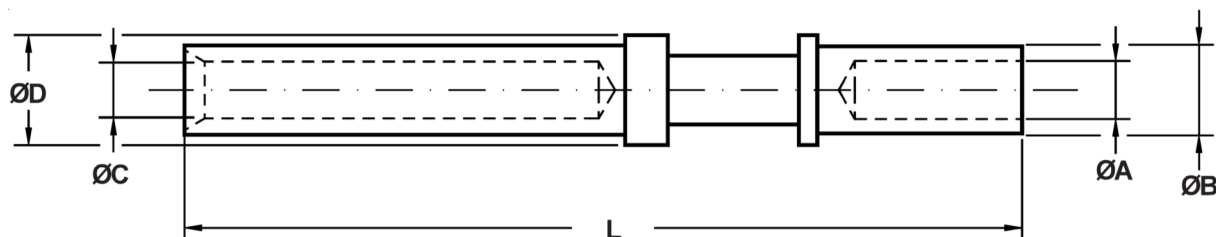
SOCKET CRIMP CONTACTS

Part Number	Size	Section mm ²	AWG	A	B ±0.1	C ±0.05	D ±0.1	L ±0.1	Modified -XX
B001-18SC T01	18	0.15 / 0.6	26 / 20	1.30	1.93	1.48	2.2	34.40	STD
B001-16SSC T01	16S	1 / 1.5	18 / 16	1.70	2.60	1.65	3.2	26.60	STD
B001-16SSC-13 T01	16S	0.15 / 0.6	26 / 20	1.30	1.93	1.65	3.2	26.65	-13
B001-16SSC-15 T01	16S	1	18	1.50	2.60	1.65	3.2	26.65	-15
B001-16SSC-20 T01	16S	2	14	2.00	2.90	1.65	3.2	26.65	-20
B001-16SC T01	16	1 / 1.5	18 / 16	1.70	2.60	1.65	3.2	36.50	STD
B001-16SC-08 T01	16	0.15 / 0.2	26 / 24	0.85	1.55	1.65	3.2	36.50	-08
B001-16SC-13 T01	16	0.15 / 0.6	26 / 20	1.30	1.93	1.65	3.2	36.50	-13
B001-16SC-15 T01	16	1	18	1.50	2.60	1.65	3.2	36.50	-15
B001-16SC-20 T01	16	2	14	2.00	2.90	1.65	3.2	36.50	-20
B001-16SC-26 T01	16	3	12	2.50	3.80	1.65	3.2	36.50	-26
B001-12SC T01	12	3	12	2.50	3.90	2.48	4.8	37.65	STD
B001-12SC-12 T01	12	0.6	20	1.20	2.60	2.48	4.8	37.65	-12
B001-12SC-20 T01	12	1 / 2	18 / 14	2.00	3.80	2.48	4.8	37.65	-20
B001-12SC-22 T01	12	2.5		2.20	3.80	2.48	4.8	37.65	-22
B001-12SC-30 T01	12	4		3.00	4.80	2.48	4.8	37.65	-30
B001-12SC-38 T01	12	6		3.60	4.80	2.48	4.8	37.65	-38
B001-8SC T01	8	9	8	4.50	6.75	3.70	7.8	42.00	STD
B001-8SC-50 T01	8	10		5.00	6.90	3.70	7.8	42.00	-50
B001-4SC T01	4	22	4	7.10	9.53	5.80	11.0	42.00	STD
B001-0SC T01	0	50 / 60	0	11.50	14.50	9.17	15.1	44.60	STD
B001-0SC-35 T01	0	0		9.00	14.35	9.17	15.1	44.60	-35

All crimp connectors includes silver plated contacts (T01 suffix).
 Standard and modified contacts can be supplied as spare parts.
 See our **“Assembly Instructions”** catalogue.

Insert Arrangements

INSERT ARRANGEMENT	SERVICE RATING	CONTACT NUMBER	CONTACT SIZE					ALTERNATE POSITION - DEGREE			
			0	4	8	12	16	W	X	Y	Z
18-1	I	10					10	70	145	215	290
18-3	D	2				2		35	110	250	325
18-4	D	4					4	35	110	250	325
18-6	D	1		1							
18-06	A	6				4	2		180		
18-8	A	8				1	7	70			290
18-9	I	7				2	5	80	110	250	280
18-10	A	4				4			120	240	
18-11	A	5				5			170	265	
18-12	A	6					6	80			280
18-19	A	10					10		120	240	
18-22	D	3					3	70	145	215	290
22-1	D	2			2			35	110	250	325
22-2	D	3			3			70	145	215	290
22-4	A	4			2	2		35	110	250	325
22-5	D	6				2	4	35	110	250	325
22-7	E	1	1								
22-9	E	3				3		70	145	215	290
22-12	D	5			2		3	80	110	250	280
22-14	A	19					19	80	110	250	280
22-19	A	14					14	80	110	250	280
22-21	A	3	1				2	80	110	250	280
22-22	A	4			4				110	250	
22-23	A	8				8		35		250	
22-28	A	7				7		80			280
24-2	D	7				7		80			280
24-5	A	16					16	80	110	250	280
24-6	A	8				8		80	110	250	280
24-06	D	6			4		2	40			320
24-7	A	16				2	14	80	110	250	280
24-07	D	7				7			80		280
24-9	A	2		2				35	110	250	325
24-10	A	7			7			80			280
24-11	A	9			3	6		35	110	250	325
24-19	A	12					12				

* For all non-standard insert arrangements, please contact the factory

Insert Arrangements

INSERT ARRANGEMENT	SERVICE RATING	CONTACT NUMBER	CONTACT SIZE						ALTERNATE POSITION - DEGREE			
			0	4	8	12	16	18	W	X	Y	Z
24-12	A	5		2		3			80	110	250	280
24-20	D	11				2	9		80	110	250	280
24-22	D	4			4				45	110	250	
24-A25	A	25					25		80	110	250	280
24-27	E	7					7		80			280
24-28	I	24					24		80	110	250	280
24-A28	I	28					28		65	146	235	
28-1	A	9			3	6			80	110	250	280
28-2	D	14				2	12		35	110	250	325
28-3	E	3			3				70	145	215	290
28-6	D	3		3					70	145	215	290
28-9	D	12				6	6		80	110	250	280
28-A9	A	9		4			5		110	250	260	280
28-10	A	7		2	2	3			80	110	250	280
28-11	A	22				4	18		80	110	250	280
28-12	A	26					26		90	180	270	
28-15	A	35					35		80	110	250	280
28-16	A	20					20		80	110	250	280
28-18	I	12					12		70	145	215	290
28-20	A	14				10	4		80	110	250	280
28-21	A	37					37		80	110	250	280
28-22	D	6		3			3		70	145	215	290
28-51	D	12				12			80	135	195	

Insert Arrangements Alternate Position

Normal Position

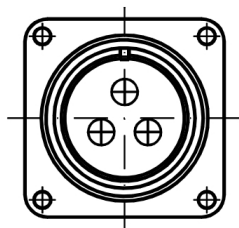

Alternate Position with socket contacts

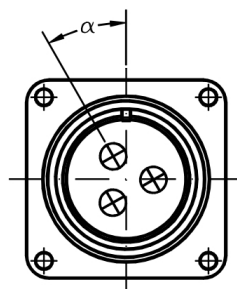

Alternate Position with pin contacts

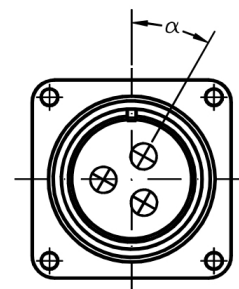

* For all non-standard insert arrangements, please contact the factory

Front View of Pin Inserts

Contact Size Legend



1 CONTACT

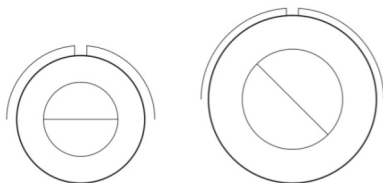

ARRANGEMENT	18-6	22-7
NO. OF CONTACTS	1	1
CONTACT SIZE	4	0
SERVICE RATING	D	E

2 CONTACTS

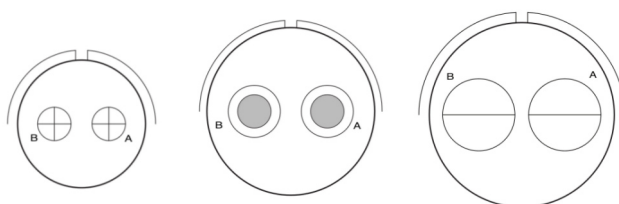

ARRANGEMENT	18-3	22-1	24-9
NO. OF CONTACTS	2	2	2
CONTACT SIZE	12	2-8	2-4
SERVICE RATING	D	D	A

3 CONTACTS

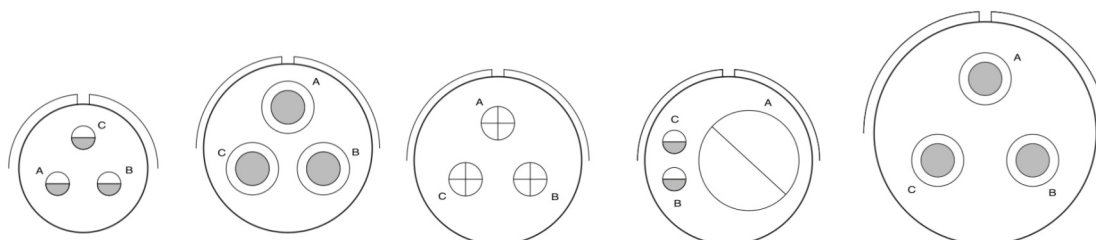

ARRANGEMENT	18-22	22-2	22-9	22-21	28-3
NO. OF CONTACTS	3	3	3	3	3
CONTACT SIZE	3-16	3-8	3-12	1-0, 2-16	3-8
SERVICE RATING	D	D	E	A	E

Contact Size Legend

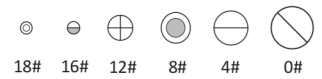

Front View of Pin Inserts

3 CONTACTS

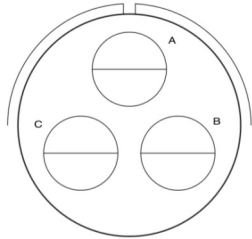

ARRANGEMENT	28-6
NO. OF CONTACTS	3
CONTACT SIZE	3-4
SERVICE RATING	D

4 CONTACTS

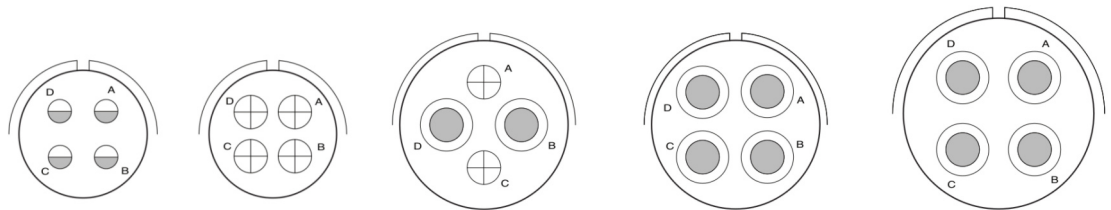

ARRANGEMENT	18-4	18-10	22-4	22-22	24-22
NO. OF CONTACTS	4	4	4	4	4
CONTACT SIZE	4-16	4-12	2-8, 2-12	4-8	4-8
SERVICE RATING	D	A	A	A	D

5 CONTACTS

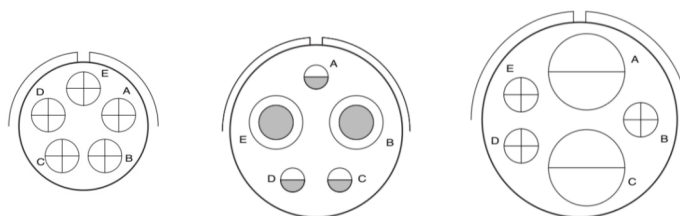

ARRANGEMENT	18-11	22-12	24-12
NO. OF CONTACTS	5	5	5
CONTACT SIZE	5-12	2-8, 3-16	2-4, 3-12
SERVICE RATING	A	D	A

Contact Size Legend



Front View of Pin Inserts

6 CONTACTS

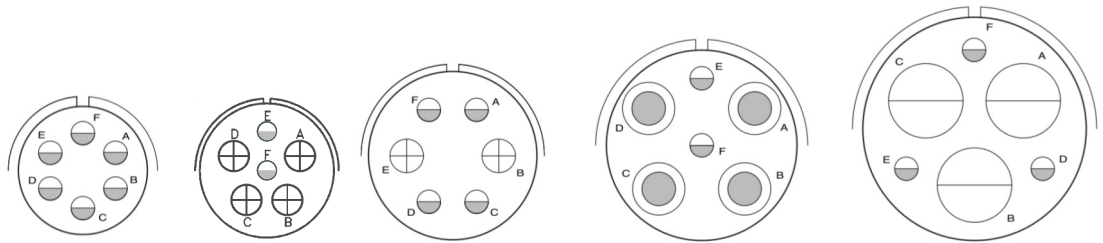

ARRANGEMENT	18-12	18-06	22-5	24-06	28-22
NO. OF CONTACTS	6	6	6	6	6
CONTACT SIZE	6-16	4-12, 2-16	2-12, 4-16	4-8, 2-16	3-4, 3-16
SERVICE RATING	A	A	D	D	D

7 CONTACTS

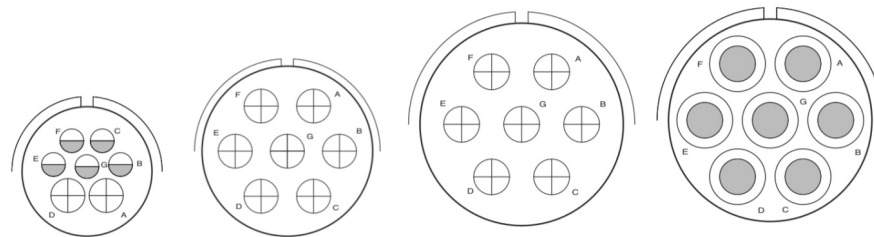

ARRANGEMENT	18-9	22-28	24-2	24-10
NO. OF CONTACTS	7	7	7	7
CONTACT SIZE	2-12, 5-16	7-12	7-12	7-8
SERVICE RATING	I	A	D	A

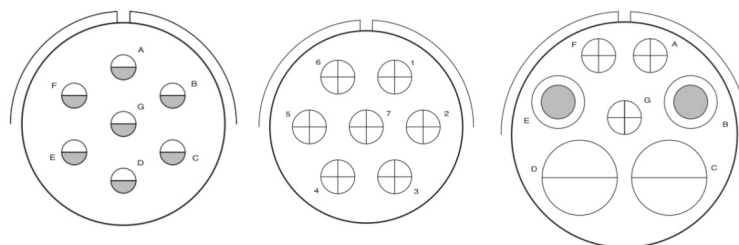

ARRANGEMENT	24-27	24-07	28-10
NO. OF CONTACTS	7	7	7
CONTACT SIZE	7-16	7-12	2-4, 3-8, 3-12
SERVICE RATING	E	D	G=D, Bal.=A

Front View of Pin Inserts

Contact Size Legend

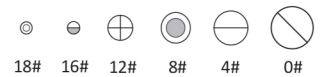

8 CONTACTS

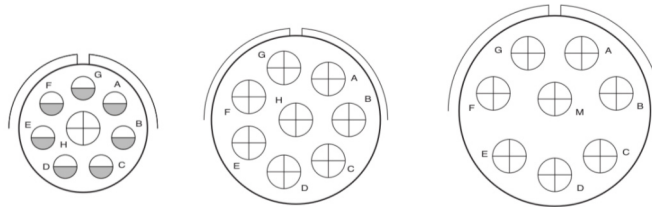

ARRANGEMENT	18-8	22-23	24-6
NO. OF CONTACTS	8	8	8
CONTACT SIZE	1-12, 7-16	8-12	8-12
SERVICE RATING	A	H=D - Bal.=A	A,G,H=D - Bal.=A

9 CONTACTS

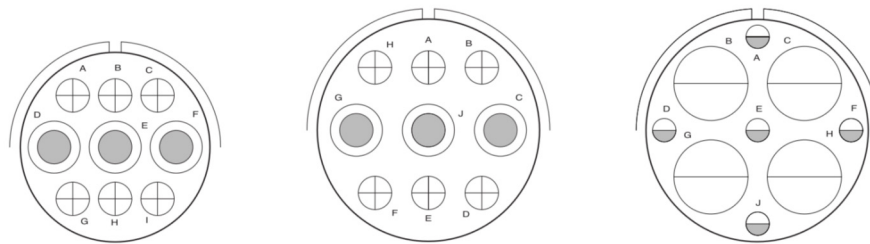

ARRANGEMENT	24-11	28-1	28A-9
NO. OF CONTACTS	9	9	9
CONTACT SIZE	3-8, 6-12	3-8, 6-12	4-4, 5-16
SERVICE RATING	A	A,J,E=D - Bal.=A	A

10 CONTACTS

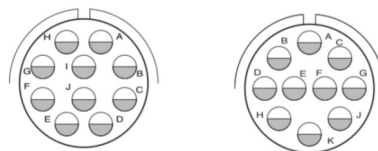

ARRANGEMENT	18-1	18-19
NO. OF CONTACTS	10	10
CONTACT SIZE	10-16	10-16
SERVICE RATING	B,C,F,G=A - Bal.=I	A

Contact Size Legend



Front View of Pin Inserts

11 CONTACTS

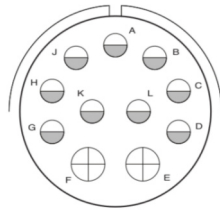

ARRANGEMENT	24-20
NO. OF CONTACTS	11
CONTACT SIZE	2-12, 9-16
SERVICE RATING	D

12 CONTACTS

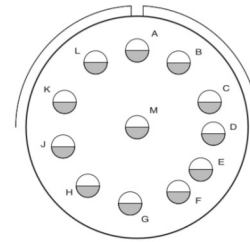
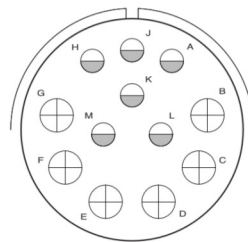
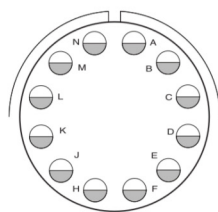

ARRANGEMENT	24-19	28-9	28-18
NO. OF CONTACTS	12	12	12
CONTACT SIZE	12-16	6-12, 6-16	12-16
SERVICE RATING	A	D	M=C - A,B=A - G,H,J,K,L=D - Bal.=I

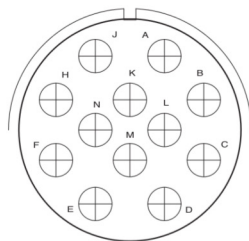

ARRANGEMENT	28-51
NO. OF CONTACTS	12
CONTACT SIZE	12-12
SERVICE RATING	D

Contact Size Legend

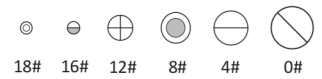

Front View of Pin Inserts

14 CONTACTS

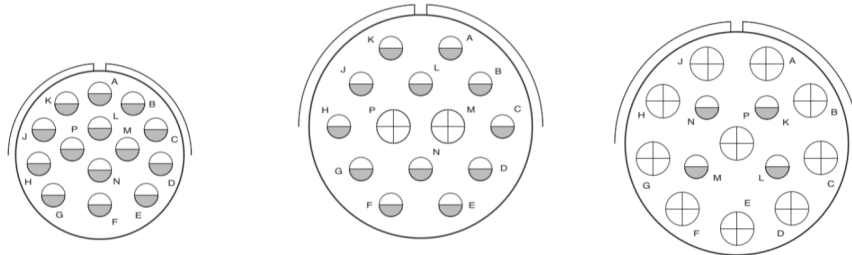

ARRANGEMENT	22-19	28-2	28-20
NO. OF CONTACTS	14	14	14
CONTACT SIZE	14-16	2-12, 12-16	10-12, 4-16
SERVICE RATING	A	D	A

16 CONTACTS

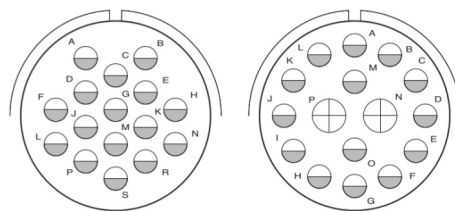

ARRANGEMENT	24-5	24-7
NO. OF CONTACTS	16	16
CONTACT SIZE	16-16	2-12, 14-16
SERVICE RATING	A	A

19 CONTACTS

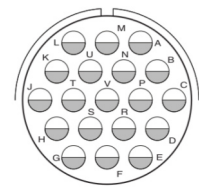

ARRANGEMENT	22-14
NO. OF CONTACTS	19
CONTACT SIZE	19-16
SERVICE RATING	A

20 CONTACTS

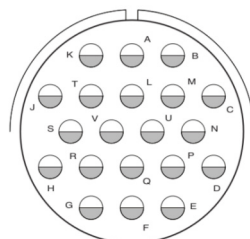

ARRANGEMENT	28-16
NO. OF CONTACTS	20
CONTACT SIZE	20-16
SERVICE RATING	A

22 CONTACTS

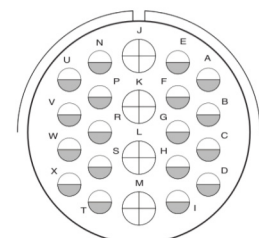

ARRANGEMENT	28-11
NO. OF CONTACTS	22
CONTACT SIZE	4-12, 18-16
SERVICE RATING	A

Contact Size Legend

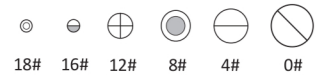

Front View of Pin Inserts

24 CONTACTS

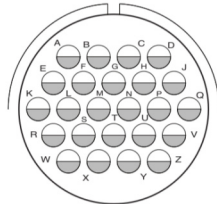

24-28

ARRANGEMENT	
NO. OF CONTACTS	24
CONTACT SIZE	24-16
SERVICE RATING	I

25 CONTACTS

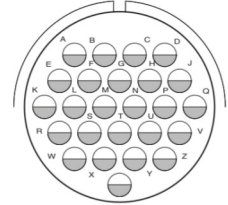

24A-25

ARRANGEMENT	
NO. OF CONTACTS	25
CONTACT SIZE	25-16
SERVICE RATING	I

26 CONTACTS

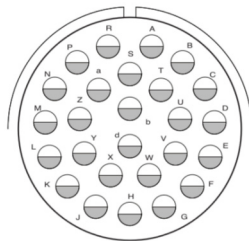

28-12

ARRANGEMENT	
NO. OF CONTACTS	26
CONTACT SIZE	26-16
SERVICE RATING	A

28 CONTACTS

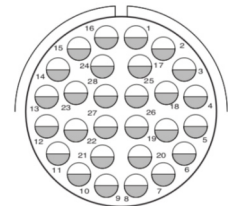

24A-28

ARRANGEMENT	
NO. OF CONTACTS	28
CONTACT SIZE	28-16
SERVICE RATING	I

35 CONTACTS

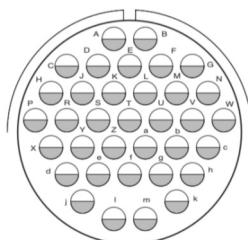

28-15

ARRANGEMENT	
NO. OF CONTACTS	35
CONTACT SIZE	35-16
SERVICE RATING	A

37 CONTACTS

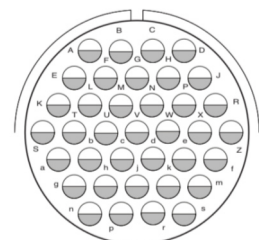

28-21

ARRANGEMENT	
NO. OF CONTACTS	37
CONTACT SIZE	37-16
SERVICE RATING	A

HOW TO ORDER

CKZ	31	06A	22-14	P	X	CGM18	T51
1	2	3	4	5	6	7	8

1 - Serie con accoppiamento a filettatura trapezoidale e o-ring antipolvere.

2 - Contatti argentati. **31**: contatti a saldare.
41: contatti a crimpare.

3 - Configurazione: **00A - 01A - 02A - 06A - 08A**.

4 - Disposizione contatti.

5 - Contatto maschio: **P**
Contatto femmina: **S**

6 - Polarizzazione inserto (omesso per standard).

7 - Classe: **MXX, PGXX, CGMXX**.

8 - **T51**: Trattamento di Zinco-Nickel nero ad elevata resistenza alla corrosione.
Conforme RoHs.

T50: Trattamento di nickel elettrolitico per ambiente industriale.

T54: Corpo in acciaio.



Classes and Styles

<p>CKZ3100A28A-9PMXXT51 CKZ3100A28A-9PPGXXT51</p> <p>Connettore a pannello con adattatore metrico o PG per serracavo o raccordo guaina.</p>	
<p>CKZ3100A28A-9PCGMXXT51</p> <p>Connettore a pannello con serracavo a tenuta ambientale e riporto di schermo.</p>	
<p>CKZ3101A28A-9PMXXT51 CKZ3101A28A-9PPGXXT51</p> <p>Connettore per giunzione volante con adattatore metrico o PG per serracavo o raccordo guaina.</p>	
<p>CKZ3101A28A-9CGMXXT51</p> <p>Connettore per giunzione volante con serracavo a tenuta ambientale e riporto di schermo.</p>	
<p>CKZ3102A28A-9PT51</p> <p>Connettore a pannello.</p>	

Classes and Styles

<p>CKZ3106A28A-9PMXXT51 CKZ3106A28A-9PPGXXT51</p> <p>Connettore volante dritto con adattatore metrico o PG per serracavo o raccordo guaina.</p>	
<p>CKZ3106A28A-9CGMXXT51</p> <p>Connettore a pannello con serracavo a tenuta ambientale e riporto di schermo.</p>	
<p>CKZ3108A28A-9PMXXT51 CKZ3108A28A-9PPGXXT51</p> <p>Connettore volante curvo con adattatore metrico o PG per serracavo o raccordo guaina.</p>	
<p>CKZ3108A28A-9CGMXXT51</p> <p>Connettore volante curvo con serracavo a tenuta ambientale e riporto di schermo.</p>	

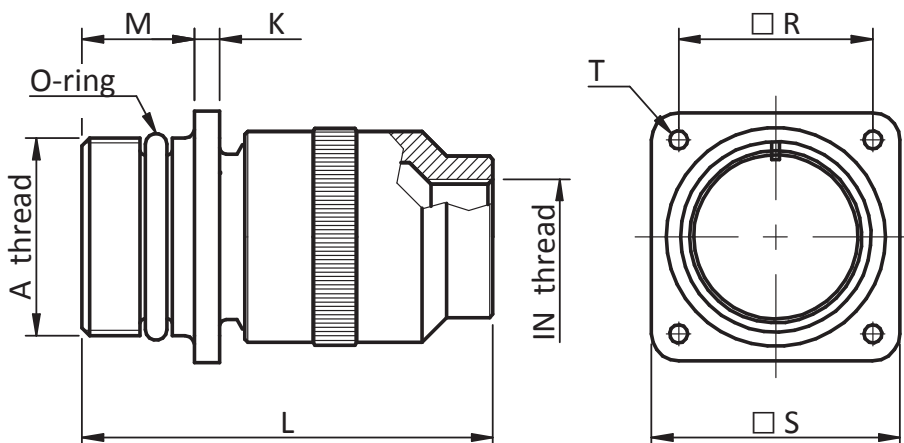
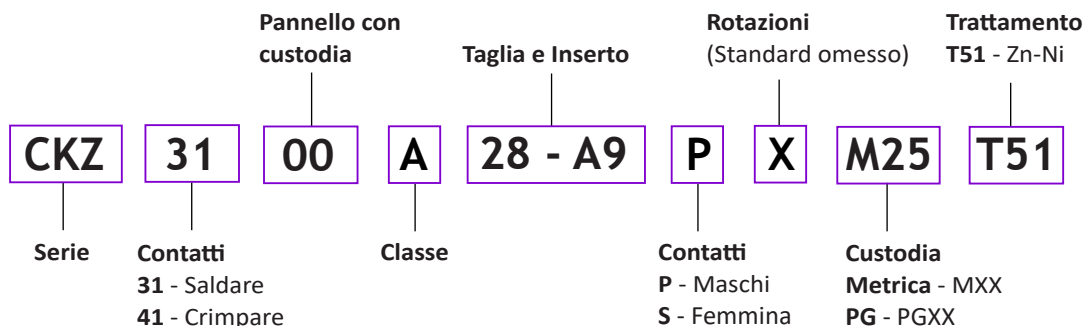
Connettore a Pannello con custodia
CKZ3100A28A-9PM25T51
CKZ3100A28A-9PPG29T51

Shell size	A Thread	L Max.	M +0,2 / -0	K ±0,2	S ±0,2	R ±0,1	T -0 / +0,1	IN Thread	
								MXX pitch 1,5	PGXX
18	Tr 30x3	66,5	19,1	4,0	35,0	27,00	3,2	M20	PG11 / PG13,5 / PG16
22	Tr 37x3	69,5	19,1	4,0	38,0	29,40	3,2	M20 / M25	PG16 / PG21
24	Tr 40x3	71,5	19,6	4,0	41,0	31,75	3,7	M25	PG21 / PG29
28	Tr 46x3	76,5	20,6	4,0	44,5	34,90	3,7	M25	PG21 / PG29

Connettore a pannello con custodia posteriore a filetto interno metrico oppure PG, per serracavo o raccordo guaina.

Connettore a Pannello con custodia e serracavo

CKZ3100A28A-9PCGMXXT51

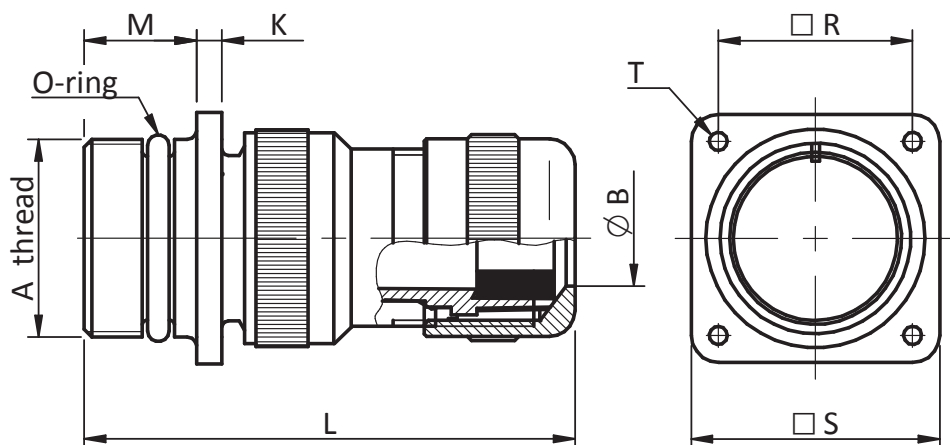
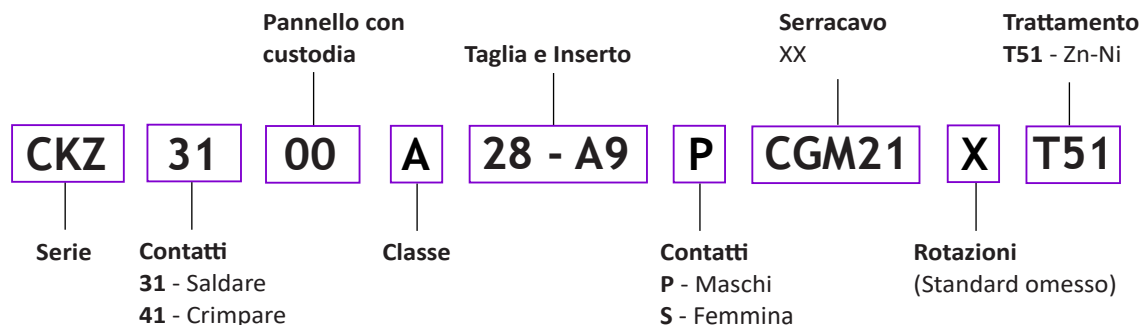

Shell size	A Thread	L Max.	M +0,2 / -0	K ±0,2	S ±0,2	R ±0,1	T -0 / +0,1	XX	B Min. - Max.
18	Tr 30x3	70,00	19,1	4,0	35,0	27,00	3,2	11 / 18	4-11 / 7-17
22	Tr 37x3	70,00	19,1	4,0	38,0	29,40	3,2	18	7-17
24	Tr 40x3	80,00	19,6	4,0	41,0	31,75	3,7	18 / 21 / 25	7-17 / 12-21 / 18-25
28	Tr 46x3	80,00	20,6	4,0	44,5	34,90	3,7	18 / 21 / 25	7-17 / 12-21 / 18-25

Connettore a pannello con serracavo posteriore a tenuta ambientale e riporto di schermo, per cavi multipolari.

Connettore per giunzione volante con custodia

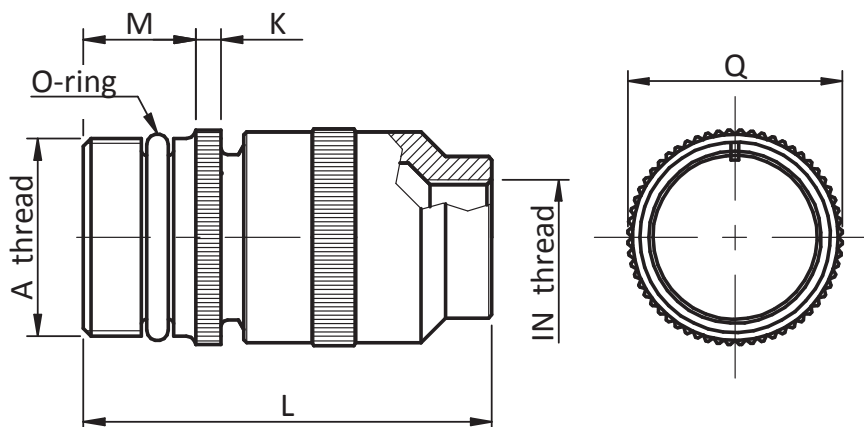
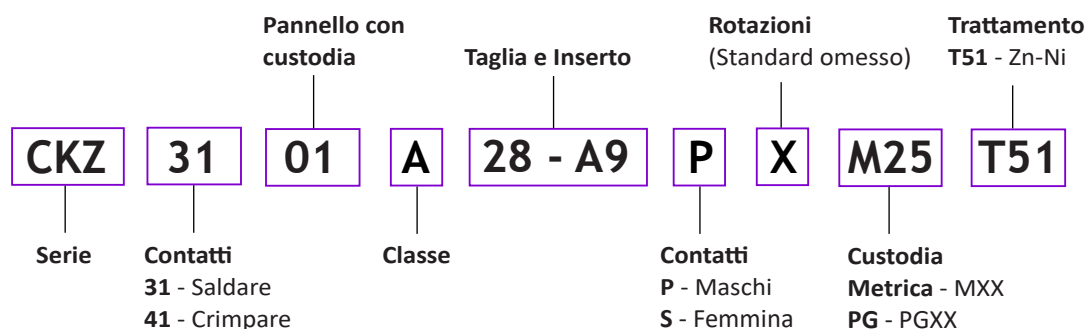
CKZ3101A28A-9PM25T51
CKZ3101A28A-9PPG29T51

Shell size	A Thread	L Max.	M +0,2 / -0	K ±0,2	Q ±0,1	IN Thread	
						MXX pitch 1,5	PGXX
18	Tr 30x3	66,5	19,1	4,0	33,8	M20	PG11 / PG13,5 / PG16
22	Tr 37x3	69,5	19,1	4,0	39,5	M20 / M25	PG16 / PG21
24	Tr 40x3	71,5	19,6	4,0	43,9	M25	PG21 / PG29
28	Tr 46x3	76,5	20,6	4,0	48,4	M25	PG21 / PG29

Connettore per giunzione volante con custodia posteriore a filetto interno metrico oppure PG, per serracavo o raccordo guaina.

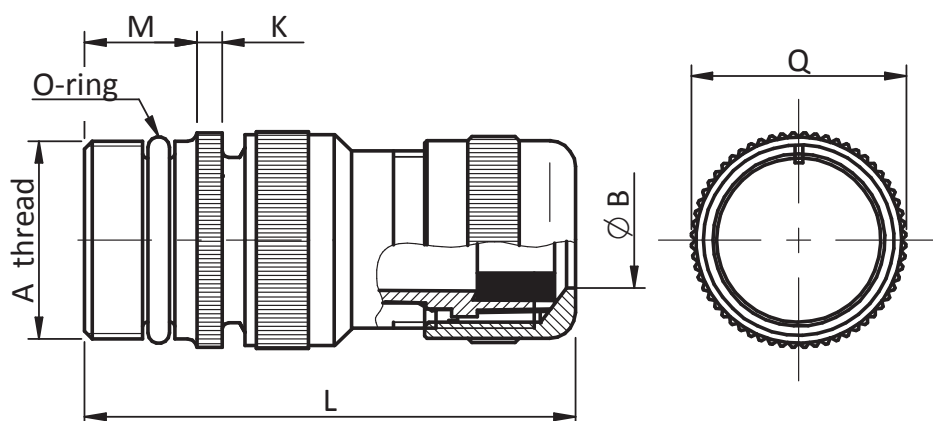
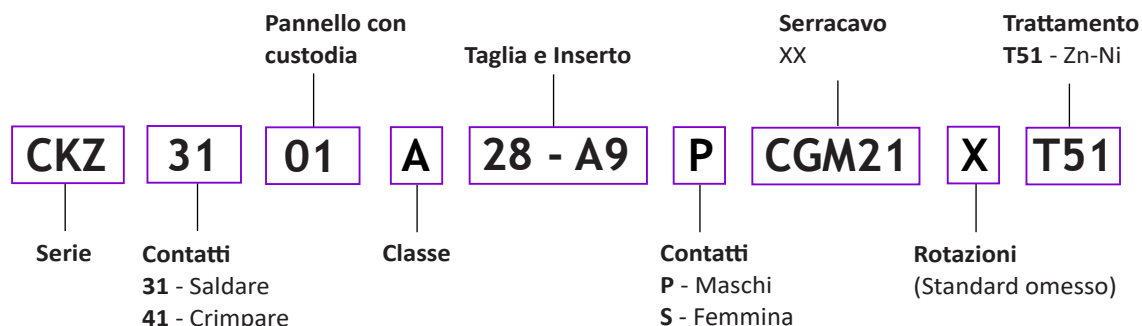
Connettore per giunzione volante con custodia e serracavo
CKZ3101A28-A9P-CGM21X-T51

Shell size	A Thread	L Max.	M +0,2 / -0	K ±0,2	Q ±0,1	XX	B Min. - Max.
18	Tr 30x3	70,0	19,1	4,0	33,8	11 / 18	4-11 / 7-17
22	Tr 37x3	70,0	19,1	4,0	39,5	18	7-17
24	Tr 40x3	80,0	19,6	4,0	43,9	18 / 21 / 25	7-17 / 12-21 / 18-25
28	Tr 46x3	80,0	20,6	4,0	48,4	18 / 21 / 25	7-17 / 12-21 / 18-25

Connettore per giunzione volante con serracavo posteriore a tenuta ambientale e riporto di schermo, per cavi multipolari.

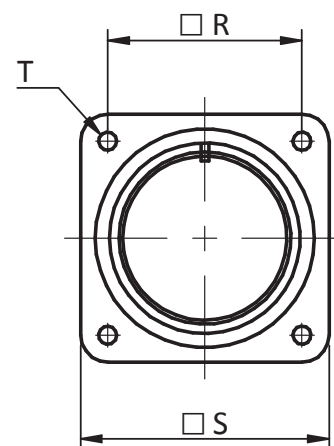
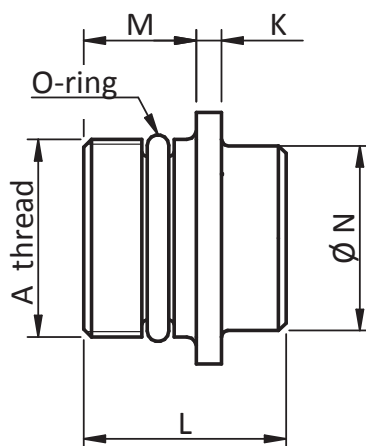
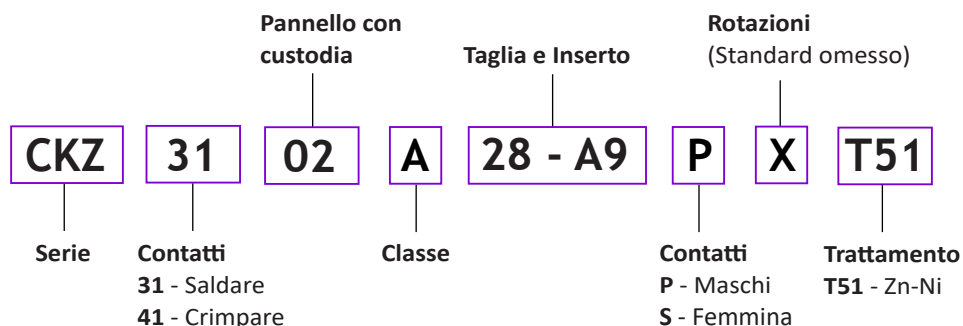
Connettore per giunzione volante con custodia
CKZ3102A28A-9PT51

Shell size	A Thread	L Max.	N Max.	M +0,2 / -0	K ±0,2	S ±0,2	R ±0,1	T -0 / +0,1
18	Tr 30x3	34,5	25,6	19,1	4,0	35,0	27,00	3,2
22	Tr 37x3	34,5	32,2	19,1	4,0	38,0	29,40	3,2
24	Tr 40x3	35,7	35,3	19,6	4,0	41,0	31,75	3,7
28	Tr 46x3	35,7	41,4	20,6	4,0	44,5	34,90	3,7

Connettore a pannello senza custodia o serracavo posteriore.

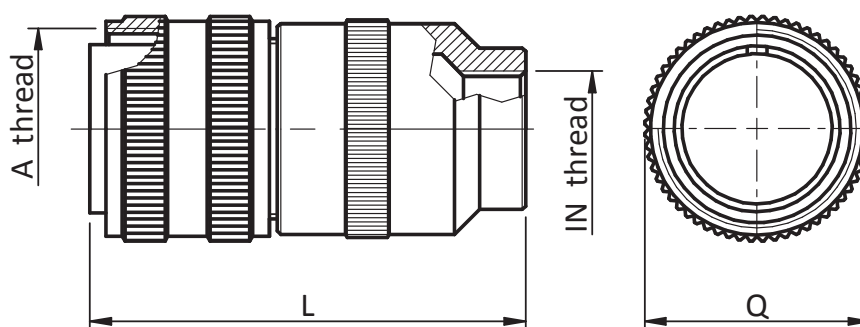
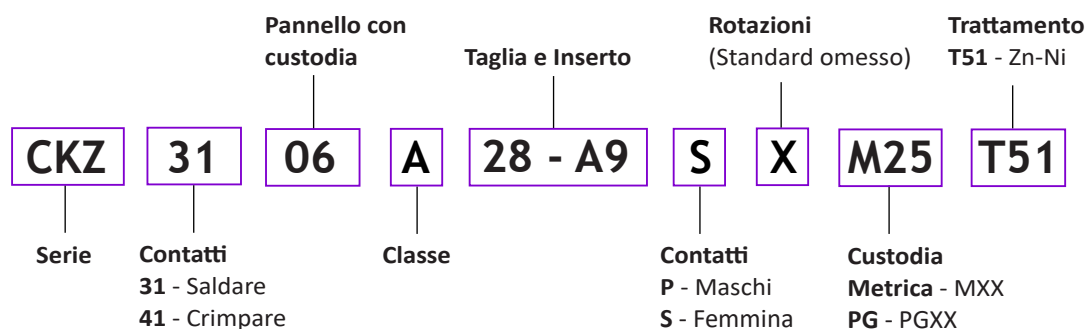
Connettore volante diritto con custodia
CKZ3106A28A-9PM25T51
CKZ3106A28A-9PPG29T51

Shell size	A Thread	L Max.	Q $\pm 0,2$	IN Thread	
				MXX pitch 1,5	PGXX
18	Tr 30x3	101,5	36,2	M20	PG11 / PG13,5 / PG16
22	Tr 37x3	104,5	43,0	M20 / M25	PG16 / PG21
24	Tr 40x3	110,5	46,4	M25	PG21 / PG29
28	Tr 46x3	115,5	53,0	M25	PG21 / PG29

Connettore volante diritto con custodia posteriore a filetto interno metrico oppure PG, per serracavo o raccordo guaina.

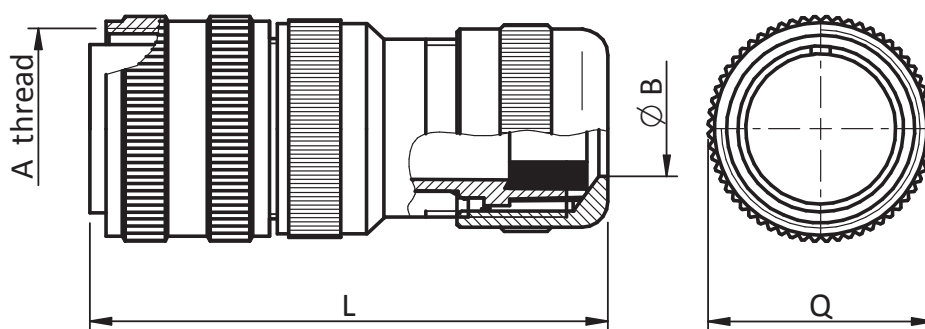
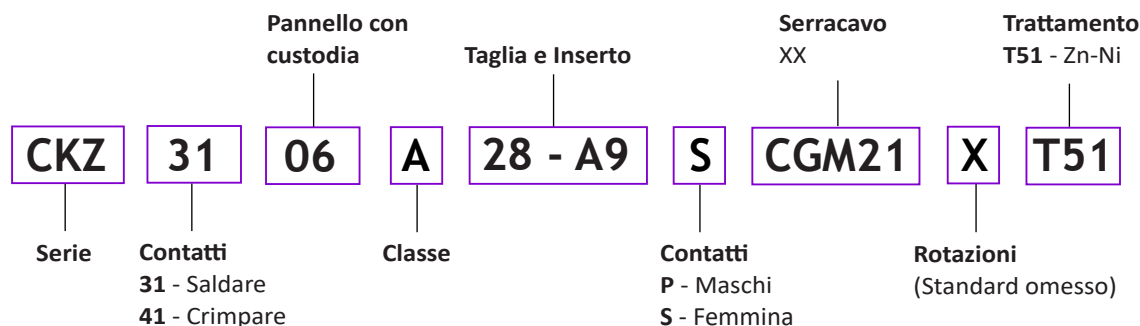
Connettore volante diritto con custodia e serracavo
CKZ3106A28A-9PCGMXXT51

Shell size	A Thread	L Max.	Q $\pm 0,2$	XX	B Min. - Max.
18	Tr 30x3	70,0	36,2	11 / 18	4-11 / 7-17
22	Tr 37x3	70,0	43,0	18	7-17
24	Tr 40x3	80,0	46,4	18 / 21 / 25	7-17 / 12-21 / 18-25
28	Tr 46x3	80,0	53,0	18 / 21 / 25	7-17 / 12-21 / 18-25

Connettore volante diritto con serracavo posteriore a tenuta ambientale e riporto di schermo, per cavi multipolari.

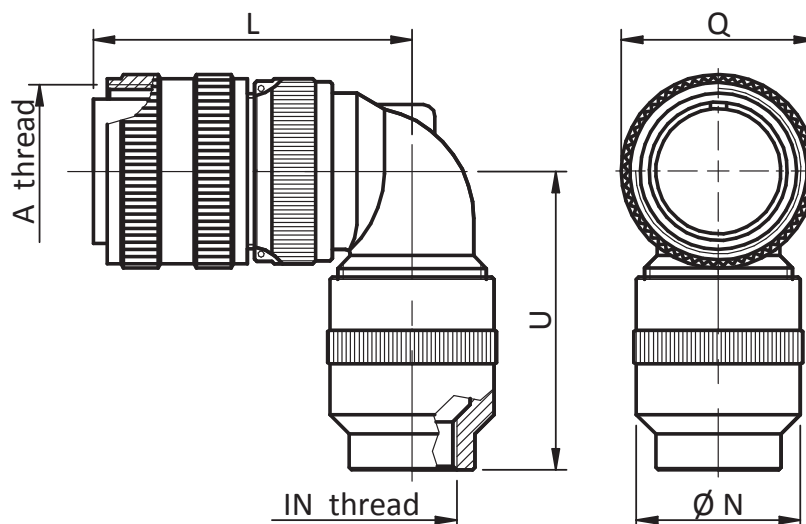
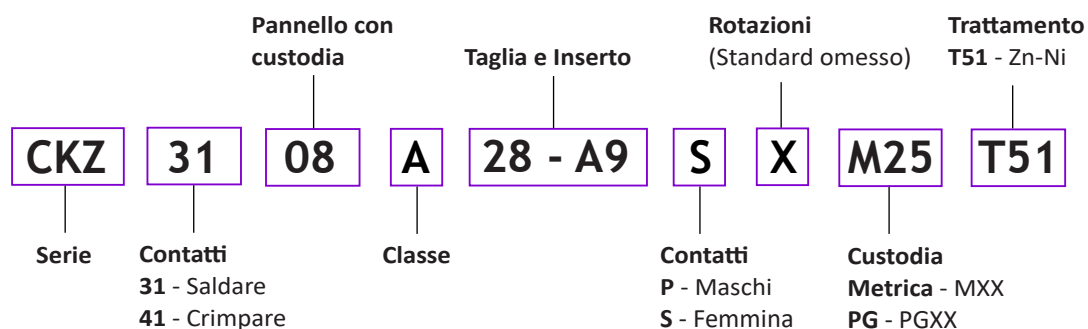
Connettore volante curvo con custodia
CKZ3108A28A-9PM25T51
CKZ3108A28A-9PPG29T51

Shell size	A Thread	L Max.	U Max.	Q $\pm 0,2$	IN Thread	
					MXX pitch 1,5	PGXX
18	Tr 30x3	57,0	54,5	36,2	M20	PG11/PG13,5/PG16
22	Tr 37x3	62,0	56,5	43,0	M20 / M25	PG16/PG21
24	Tr 40x3	67,0	61,5	46,4	M25	PG21/PG29
28	Tr 46x3	67,0	62,5	53,0	M25	PG21/PG29

Connettore volante curvo con custodia posteriore a filetto interno metrico oppure PG, per serracavo o raccordo guaina.

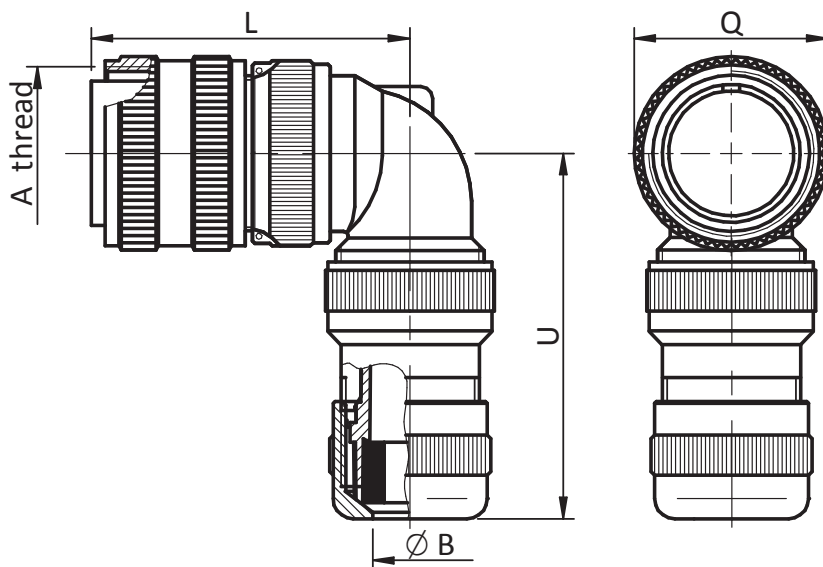
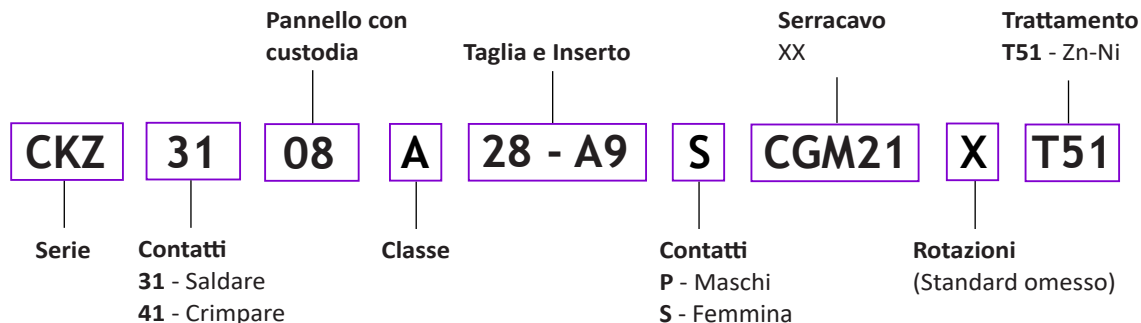
Connettore volante curvo con custodia e serracavo
CKZ3108A28-9PCGMXXT51

Shell size	A Thread	L Max.	U Max.	Q $\pm 0,2$	XX	B Min. - Max.
18	Tr 30x3	57,0	54,5	36,2	11 / 18	4-11 / 7-17
22	Tr 37x3	62,0	56,5	43,0	18	7-17
24	Tr 40x3	67,0	61,5	46,4	18 / 21 / 25	7-17 / 12-21 / 18-25
28	Tr 46x3	67,0	62,5	53,0	18 / 21 / 25	7-17 / 12-21 / 18-25

Connettore volante curvo con serracavo posteriore a tenuta ambientale e riporto di schermo, per cavi multipolari.

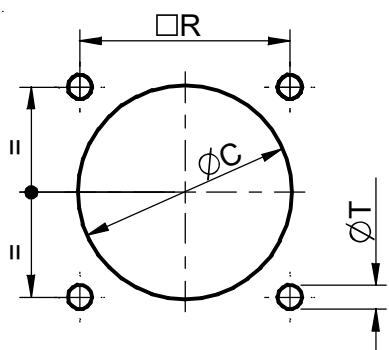
Foratura pannello

Shell size	R $\pm 0,1$	H	C	T
18	27,0	13,5	26,5	3,4
22	31,8	15,9	33,0	3,4
24	34,9	17,5	34,9	3,9
28	39,7	19,9	39,7	3,9

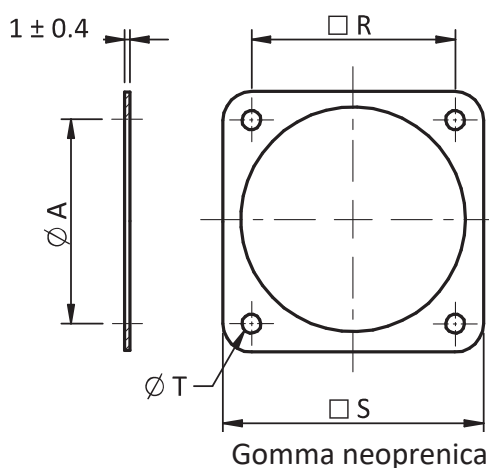
Guarnizione per connettore fisso

Part number	Shell size	A $\pm 0,1$	R $\pm 0,2$	S $\pm 0,5$	T $\pm 0,5$
B096-18	18,0	30,8	27,0	35,0	4,2
B096-22	22,0	37,4	31,8	41,0	4,2
B096-24	24,0	40,9	34,9	44,5	4,2
B096-28	28,0	46,7	39,7	50,8	5,1

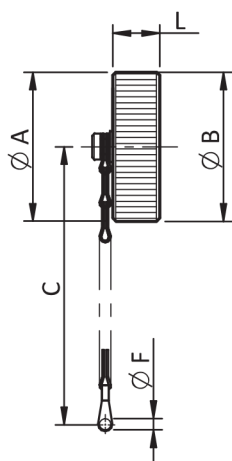
Tappi di protezione
Tappi per connettore fisso

Part number	Shell size	A Max.	B Thread	C Min.	L	F $+0.25 / -0.13$
CKZ02-18-1CT51	18	36,4	Tr 30x3	115,0	11,9	3,5
CKZ02-22-1CT51	22	43,0	Tr 37x3	127,0	11,9	3,5
CKZ02-24-1CT51	24	46,5	Tr 40x3	140,0	11,9	4,3
CKZ02-28-1CT51	28	54,0	Tr 46x3	197,0	13,5	4,3

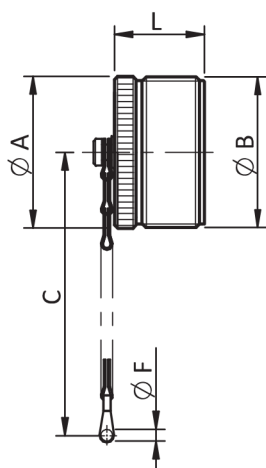
Tappi per connettore volante

Part number	Shell size	A Max.	B Thread	C Min.	L	F $+0.25 / -0.13$
CKZ06-18-1CT51	18	30,0	Tr 30x3	115,0	21,4	3,5
CKZ06-22-1CT51	22	36,4	Tr 37x3	127,0	21,4	3,5
CKZ06-24-1CT51	24	39,6	Tr 40x3	140,0	21,4	4,3
CKZ06-28-1CT51	28	46,0	Tr 46x3	197,0	21,4	4,3



CKM CONNECTORS
MIL-C-5015 POWER AND SIGNAL THREADED CONNECTORS FOR RUGGED MILITARY AND INDUSTRIAL APPLICATIONS



CKP CONNECTORS
MIL-C-26482 HIGH DENSITY SIGNAL BAYONET CONNECTORS FOR RUGGED MILITARY AND INDUSTRIAL APPLICATIONS



CKB CONNECTORS
MIL-C-5015 REVERSE BAYONET POWER AND SIGNAL CONNECTORS FOR HARSH ENVIRONMENTAL APPLICATIONS



CONNETTORI PNEUMATICI ED ELETTROPNEUMATICI



CONNETTORI PER ALTE TEMPERATURE
CARATTERISTICHE TECNICHE IN ACCORDO ALLE NORME MIL-DTL-5015, MIL-DTL-26482 E VG95234 PER TEMPERATURE FINO A 250 °C



SERIE CKV
CONNETTORI METRICI PER IMPIEGHI GRAVOSI ED ELEVATE PRESTAZIONI



SERIE CKGE
CONNETTORI DI POTENZA VG96929 E VG95234 COMPATIBILI



SERIE CKZ
CONNETTORI CIRCOLARI AD ELEVATE PRESTAZIONI



SERIE CKO
CAVI TRASMISSIONE DATI AD ELEVATE PRESTAZIONI



 **Connitek**
Connector and Accessories

Huge Connectors Experience

Deep Industrial Market Knowledge

Really Customer Oriented

CONNITEK S.r.l.

Via Puccini, 26
40055 - Villanova di Castenaso
Bologna - Italy
Tel.: +39 051 / 4380258
Fax.: +39 051 / 4380259
e-mail: sales@connitek.it
www.connitek.it

CONNITEK S.r.l. Authorized Reseller